



27 Belmore Park

Ashford, TN24 8UW

Price £325,000

A spacious terraced home in pleasant cul de sac position, just a short walk to Highworth Grammar School and Ashford town centre.

Offered for sale with no onward chain this well appointed home comprises an entrance hall, cloakroom, kitchen, sitting room, dining room, three double bedrooms and bathroom/WC. The enclosed rear garden enjoys a sunny aspect whilst to the front you will find a driveway providing off road parking for two cars. Local amenities are readily accessible as is the mainline train station connecting to London in 38 minutes (high speed).

Viewing

Please contact our Ashford Office on 01233 646411 if you wish to arrange a viewing appointment for this property or require further information.

- SPACIOUS TERRACED HOME
- THREE BEDROOMS
- LARGE BATHROOM
- GROUND FLOOR CLOAKROOM
- TWO RECEPTION ROOMS
- DRIVEWAY PROVIDING OFF ROAD PARKING
- ENCLOSED REAR GARDEN
- CLOSE TO TOWN CENTRE & LOCAL SCHOOLS
- NO ONWARD CHAIN



Floor Plan

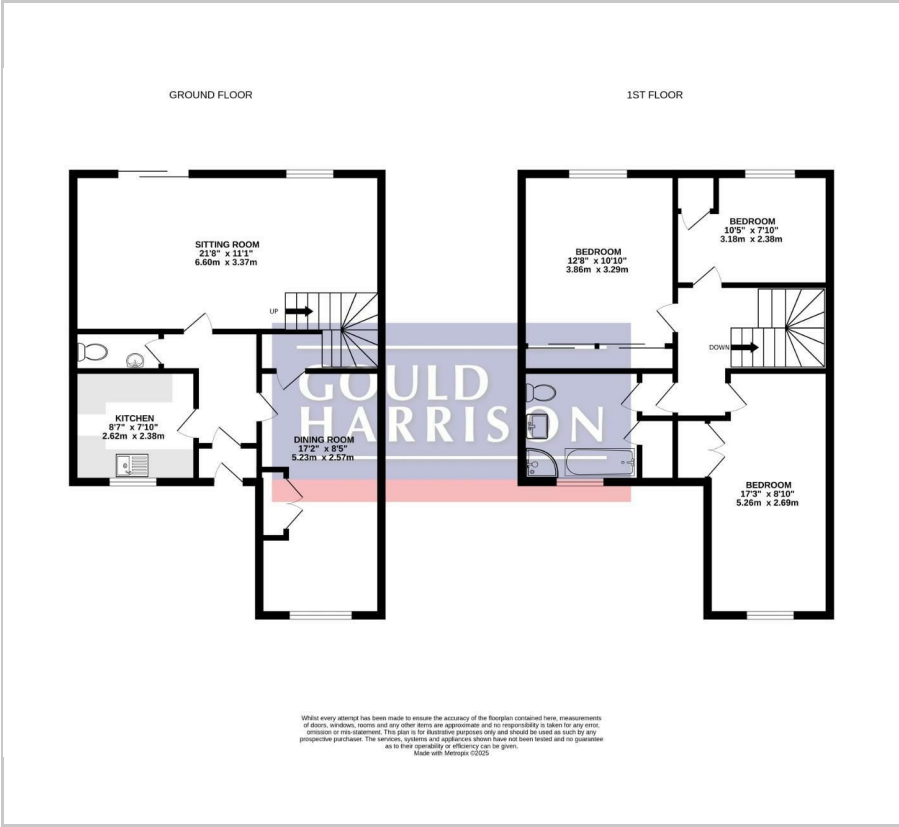

Area Map



Energy Efficiency Graph

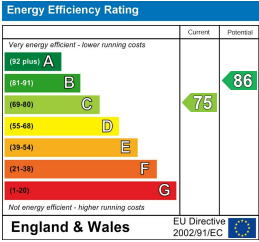

These particulars, whilst believed to be accurate are set out as a general outline only for guidance and do not constitute any part of an offer or contract. Intending purchasers should not rely on them as statements of representation of fact, but must satisfy themselves by inspection or otherwise as to their accuracy. No person in this firm's employment has the authority to make or give any representation or warranty in respect of the property.